

## Aste elicoidali per sistemi CFA Helicoidal Pipes for CFA system

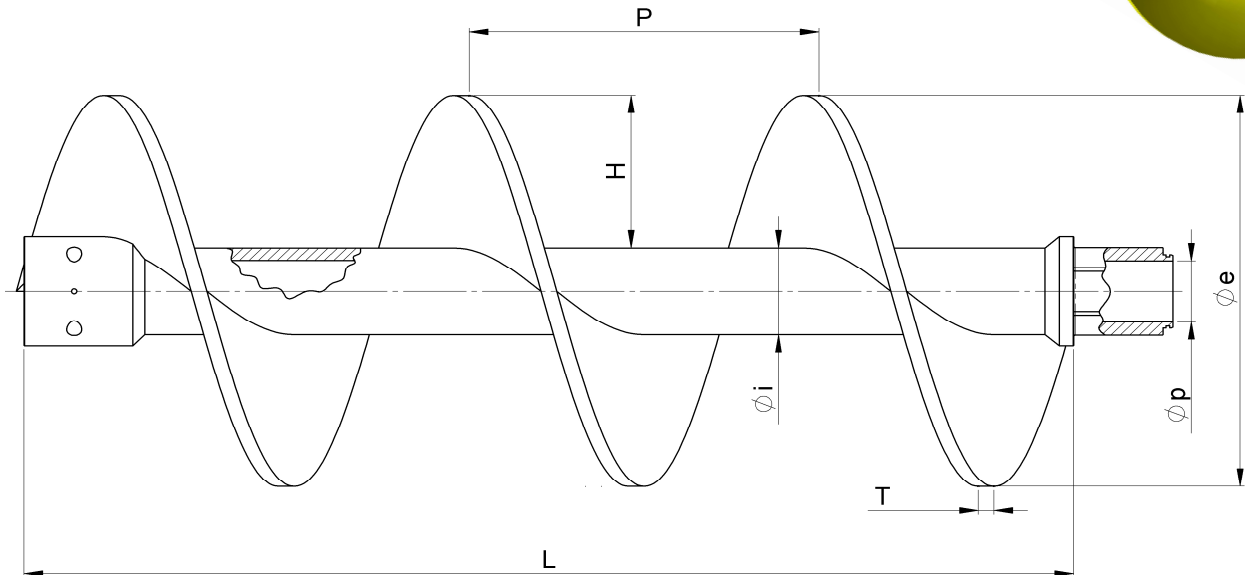
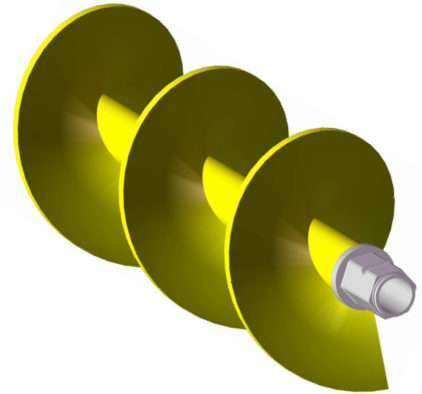

Diam. esterno	D. interno (D. tubo) x spess. tubo	Passo	Spessore Spira	Alt. spira	Mom. torcente massimo		D. pass. interno	Attacco	Lungh.	Codice
External Diam.	Internal Diam. (Pipe Diam.) x pipe th.	Pitch	Flight Thickness	Flight height	Maximum torque		Internal hole diam.	Coupl.	Length	Part Number
Øe (mm)	Øi (mm)	P (mm)	T (mm)	H (mm)	N · m	Ton · m	Øp (mm)		L (mm)	
180	101 x 12,5	200	8	40	29000	3	50 (~2")	80/50	1600	CF0A018-150-80-11-1
									3000	CF0A018-300-80-11-1
									6000	CF0A018-600-80-11-1
200	114 x 10	200	10	43	44000	4,5	50 (~2")	80/50	1600	CF0A020-150-80-12-2
									3000	CF0A020-300-80-12-2
									6000	CF0A020-600-80-12-2
	114 x 10	200	10	43	44000	4,5	80 (~3")	120/80	1600	CF0A020-150-12-12-2
									3000	CF0A020-300-12-12-2
									6000	CF0A020-600-12-12-2
	127 x 10	200	10	37	59000	6	80 (~3")	120/80	1600	CF0A020-150-12-13-2
									3000	CF0A020-300-12-13-2
									6000	CF0A020-600-12-13-2
	139 x 20	200	10	31	103000	10,5	80 (~3")	120/80	1600	CF0A020-150-12-14-2
									3000	CF0A020-300-12-14-2
									6000	CF0A020-600-12-14-2
250	114 x 10	250	12	68	44000	4,5	50 (~2")	80/50	1500	CF0A025-150-80-12-3
									3000	CF0A025-300-80-12-3
									6000	CF0A025-600-80-12-3
	114 x 10	250	12	68	44000	4,5	80 (~3")	120/80	1500	CF0A025-150-12-12-3
									3000	CF0A025-300-12-12-3
									6000	CF0A025-600-12-12-3
	127 x 10	250	12	62	59000	6	80 (~3")	120/80	1500	CF0A025-150-12-13-3
									3000	CF0A025-300-12-13-3
									6000	CF0A025-600-12-13-3
	139 x 20	250	12	56	103000	10,5	80 (~3")	120/80	1500	CF0A025-150-12-14-3
									3000	CF0A025-300-12-14-3
									6000	CF0A025-600-12-14-3

Diam. esterno	D. interno (D. tubo) x spess. tubo	Passo	Spessore Spira	Alt. spira	Mom. torcente massimo		D. pass. interno	Attacco	Lungh.	Codice
External Diam.	Internal Diam. (Pipe Diam.) x pipe th.	Pitch	Flight Thickness	Flight height	Maximum torque		Internal hole diam.	Coupl.	Length	Part Number
Øe (mm)	Øi (mm)	P (mm)	T (mm)	H (mm)	N · m	Ton · m	Øp (mm)		L (mm)	
300	114 x 10	250	14	93	44000	4,5	50 (~2")	80/50	1500	CF0A030-150-80-12-4
									3000	CF0A030-300-80-12-4
									6000	CF0A030-600-80-12-4
	114 x 10	250	14	93	44000	4,5	80 (~3")	120/80	1500	CF0A030-150-12-12-4
									3000	CF0A030-300-12-12-4
									6000	CF0A030-600-12-12-4
	127 x 10	250	14	87	59000	6	80 (~3")	120/80	1500	CF0A030-150-12-13-4
									3000	CF0A030-300-12-13-4
									6000	CF0A030-600-12-13-4
	139 x 20	250	14	81	103000	10,5	100 (~4")	HD4	1500	CF0A030-150-H4-14-4
									3000	CF0A030-300-H4-14-4
									6000	CF0A030-600-H4-14-4
350	114 x 10	250	14	118	44000	4,5	50 (~2")	80/50	1500	CF0A035-150-80-12-4
									3000	CF0A035-300-80-12-4
									6000	CF0A035-600-80-12-4
	114 x 10	250	14	118	44000	4,5	80 (~3")	120/80	1500	CF0A035-150-12-12-4
									3000	CF0A035-300-12-12-4
									6000	CF0A035-600-12-12-4
	127 x 10	250	14	112	59000	6	80 (~3")	120/80	1500	CF0A035-150-12-13-4
									3000	CF0A035-300-12-13-4
									6000	CF0A035-600-12-13-4
	139 x 20	250	14	106	103000	10,5	100 (~4")	HD4	1500	CF0A035-150-H4-14-4
									3000	CF0A035-300-H4-14-4
									6000	CF0A035-600-H4-14-4
	152,4 x 14,2	250	14	124	118000	12	125 (~5")	160/125	1500	CF1A035-150-80-15-4
									3000	CF1A035-300-80-15-4
									6000	CF1A035-600-80-15-4
	159 x 16	250	20	96	147000	15	125 (~5")	160/125	1500	CF2A035-150-16-16-5
									3000	CF2A035-300-16-16-5
									6000	CF2A035-600-16-16-5
168 x 20	250	20	91	177000	18	125 (~5")	160/125	1500	CF3A035-150-16-17-5	
								3000	CF3A035-300-16-17-5	
								6000	CF3A035-600-16-17-5	
400	127 x 10	400	14	137	59000	6	80 (~3")	120/80	1600	CF0A040-150-12-13-4
									3200	CF0A040-300-12-13-4
									6000	CF0A040-600-12-13-4
	139 x 20	400	14	131	103000	10,5	125 (~5")	160/125	1600	CF0A040-150-16-14-4
									3200	CF0A040-300-16-14-4
									6000	CF0A040-600-16-14-4
	152,4 x 14,2	400	14	124	118000	12	125 (~5")	160/125	1600	CF1A040-150-16-15-4
									3200	CF1A040-300-16-15-4
									6000	CF1A040-600-16-15-4
	159 x 16	400	14	96	147000	15	125 (~5")	160/125	1600	CF2A040-150-16-16-4
									3200	CF2A040-300-16-16-4
									6000	CF2A040-600-16-16-4
	168 x 20	400	20	91	177000	18	125 (~5")	160/125	1600	CF3A040-150-16-17-5
									3200	CF3A040-300-16-17-5
									6000	CF3A040-600-16-17-5
	177,8 x 20	400	20	86	216000	22	125 (~5")	XHD5	1600	CF4A040-150-X5-18-5
									3200	CF4A040-300-X5-18-5
									6000	CF4A040-600-X5-18-5
	219 x 20 133 x 4 <i>Doppio tubo coassiale</i> <i>Double coaxial pipe</i>	400	20	66	245000	25	125 (~5")	200/125	1600	CF5A040-150-20-D1-5
									3200	CF5A040-300-20-D1-5
									6000	CF5A040-600-20-D1-5

Diam. esterno	D. interno (D. tubo) x spess. tubo	Passo	Spessore Spira	Alt. spira	Mom. torcente massimo		D. pass. interno	Attacco	Lungh.	Codice
External Diam.	Internal Diam. (Pipe Diam.) x pipe th.	Pitch	Flight Thickness	Flight height	Maximum torque		Internal hole diam.	Coupl.	Length	Part Number
Øe (mm)	Øi (mm)	P (mm)	T (mm)	H (mm)	N · m	Ton · m	Øp (mm)		L (mm)	
450	152,4 x 25	400	14	149	103000	10,5	100 (~4")	HD4	1600	CF0A045-150-H4-15-4
									3200	CF0A045-300-H4-15-4
									6000	CF0A045-600-H4-15-4
	152,4 x 14,2	400	14	149	118000	12	125 (~5")	160/125	1600	CF1A045-150-16-15-4
									3200	CF1A045-300-16-15-4
									6000	CF1A045-600-16-15-4
	152,4 x 14,2	400	14	149	118000	12	125 (~5")	HD5	1600	CF1A045-150-H5-15-4
									3200	CF1A045-300-H5-15-4
									6000	CF1A045-600-H5-15-4
	159 x 16	400	14	146	147000	15	125 (~5")	160/125	1600	CF2A045-150-16-16-4
									3200	CF2A045-300-16-16-4
									6000	CF2A045-600-16-16-4
	159 x 16	400	14	146	147000	15	125 (~5")	HD5	1600	CF2A045-150-H5-16-4
									3200	CF2A045-300-H5-16-4
									6000	CF2A045-600-H5-16-4
	168 x 20	400	20	141	177000	18	125 (~5")	160/125	1600	CF3A045-150-16-17-5
									3200	CF3A045-300-16-17-5
									6000	CF3A045-600-16-17-5
	168 x 20	400	20	141	177000	18	125 (~5")	HD5	1600	CF3A045-150-H5-17-5
									3200	CF3A045-300-H5-17-5
									6000	CF3A045-600-H5-17-5
	177,8 x 20	400	20	136	216000	22	125 (~5")	XHD5	1600	CF4A045-150-X5-18-5
									3200	CF4A045-300-X5-18-5
									6000	CF4A045-600-X5-18-5
177,8 x 20	400	20	136	216000	22	125 (~5")	HD5	1600	CF4A045-150-H5-18-5	
								3200	CF4A045-300-H5-18-5	
								6000	CF4A045-600-H5-18-5	
219 x 20 133 x 4 <i>Doppio tubo coassiale Double coaxial pipe</i>	400	20	116	245000	25	125 (~5")	200/125	1600	CF5A045-150-20-D1-5	
								3200	CF5A045-300-20-D1-5	
								6000	CF5A045-600-20-D1-5	
219 x 20 133 x 4 <i>Doppio tubo coassiale Double coaxial pipe</i>	400	20	116	245000	25	125 (~5")	XHD5	1600	CF5A045-150-X5-D1-5	
								3200	CF5A045-300-X5-D1-5	
								6000	CF5A045-600-X5-D1-5	
500	152,4 x 25	400	14	174	103000	10,5	100 (~4")	HD4	1600	CF0A050-150-H4-15-4
									3200	CF0A050-300-H4-15-4
									6000	CF0A050-600-H4-15-4
	152,4 x 14,2	400	14	174	118000	12	125 (~5")	160/125	1600	CF1A050-150-16-15-4
									3200	CF1A050-300-16-15-4
									6000	CF1A050-600-16-15-4
	152,4 x 14,2	400	14	174	118000	12	125 (~5")	HD5	1600	CF1A050-150-H5-15-4
									3200	CF1A050-300-H5-15-4
									6000	CF1A050-600-H5-15-4
	159 x 16	400	14	171	147000	15	125 (~5")	160/125	1600	CF2A050-150-16-16-4
									3200	CF2A050-300-16-16-4
									6000	CF2A050-600-16-16-4
	159 x 16	400	14	171	147000	15	125 (~5")	HD5	1600	CF2A050-150-H5-16-4
									3200	CF2A050-300-H5-16-4
									6000	CF2A050-600-H5-16-4
	168 x 20	400	20	166	177000	18	125 (~5")	160/125	1600	CF3A050-150-16-17-5
									3200	CF3A050-300-16-17-5
									6000	CF3A050-600-16-17-5
	168 x 20	400	20	166	177000	18	125 (~5")	HD5	1600	CF3A050-150-H5-17-5
									3200	CF3A050-300-H5-17-5
									6000	CF3A050-600-H5-17-5
	177,8 x 20	400	20	161	216000	22	125 (~5")	XHD5	1600	CF4A050-150-X5-18-5
									3200	CF4A050-300-X5-18-5
									6000	CF4A050-600-X5-18-5
177,8 x 20	400	20	161	216000	22	125 (~5")	HD5	1600	CF4A050-150-H5-18-5	
								3200	CF4A050-300-H5-18-5	
								6000	CF4A050-600-H5-18-5	

Diam. esterno	D. interno (D. tubo) x spess. tubo	Passo	Spessore Spira	Alt. spira	Mom. torcente massimo		D. pass. interno	Attacco	Lung.	Codice
External Diam.	Internal Diam. (Pipe Diam.) x pipe th.	Pitch	Flight Thickness	Flight height	Maximum torque		Internal hole diam.	Coupl.	Length	Part Number
Øe (mm)	Øi (mm)	P (mm)	T (mm)	H (mm)	N · m	Ton · m	Øp (mm)		L (mm)	
500	219 x 20 133 x 4 <i>Doppio tubo coassiale Double coaxial pipe</i>	400	20	141	245000	25	125 (~5")	200/125	1600	CF5A050-150-20-D1-5
									3200	CF5A050-300-20-D1-5
									6000	CF5A050-600-20-D1-5
	219 x 20 133 x 4 <i>Doppio tubo coassiale Double coaxial pipe</i>	400	20	141	245000	25	125 (~5")	XHD5	1600	CF5A050-150-X5-D1-5
									3200	CF5A050-300-X5-D1-5
									6000	CF5A050-600-X5-D1-5
	273 x 20 133 x 4 <i>Doppio tubo coassiale Double coaxial pipe</i>	400	20	114	294000	30	125 (~5")	200/125X	1600	CF6A050-150-2X-D2-5
									3200	CF6A050-300-2X-D2-5
									6000	CF6A050-600-2X-D2-5
	273 x 20 133 x 4 <i>Doppio tubo coassiale Double coaxial pipe</i>	400	20	114	294000	30	125 (~5")	25-HD5	1600	CF6A050-150-25-D2-5
									3200	CF6A050-300-25-D2-5
									6000	CF6A050-600-25-D2-5
600	152,4 x 25	500	14	224	103000	10,5	100 (~4")	HD4	1500	CF0A060-150-H4-15-4
									3000	CF0A060-300-H4-15-4
									6000	CF0A060-600-H4-15-4
	152,4 x 14,2	500	14	224	118000	12	125 (~5")	160/125	1500	CF1A060-150-16-15-4
									3000	CF1A060-300-16-15-4
									6000	CF1A060-600-16-15-4
	152,4 x 14,2	500	14	224	118000	12	125 (~5")	HD5	1500	CF1A060-150-H5-15-4
									3000	CF1A060-300-H5-15-4
									6000	CF1A060-600-H5-15-4
	159 x 16	500	14	221	147000	15	125 (~5")	160/125	1500	CF2A060-150-16-16-4
									3000	CF2A060-300-16-16-4
									6000	CF2A060-600-16-16-4
	159 x 16	500	14	221	147000	15	125 (~5")	HD5	1500	CF2A060-150-H5-16-4
									3000	CF2A060-300-H5-16-4
									6000	CF2A060-600-H5-16-4
	168 x 20	500	20	216	177000	18	125 (~5")	160/125	1500	CF3A060-150-16-17-5
									3000	CF3A060-300-16-17-5
									6000	CF3A060-600-16-17-5
	168 x 20	500	20	216	177000	18	125 (~5")	HD5	1500	CF3A060-150-H5-17-5
									3000	CF3A060-300-H5-17-5
									6000	CF3A060-600-H5-17-5
	177,8 x 20	500	20	211	216000	22	125 (~5")	XHD5	1500	CF4A060-150-X5-18-5
									3000	CF4A060-300-X5-18-5
									6000	CF4A060-600-X5-18-5
177,8 x 20	500	20	211	216000	22	125 (~5")	HD5	1500	CF4A060-150-H5-18-5	
								3000	CF4A060-300-H5-18-5	
								6000	CF4A060-600-H5-18-5	
219 x 20 133 x 4 <i>Doppio tubo coassiale Double coaxial pipe</i>	500	20	191	245000	25	125 (~5")	200/125	1500	CF5A060-150-20-D1-5	
								3000	CF5A060-300-20-D1-5	
								6000	CF5A060-600-20-D1-5	
219 x 20 133 x 4 <i>Doppio tubo coassiale Double coaxial pipe</i>	500	20	191	245000	25	125 (~5")	XHD5	1500	CF5A060-150-X5-D1-5	
								3000	CF5A060-300-X5-D1-5	
								6000	CF5A060-600-X5-D1-5	
273 x 20 133 x 4 <i>Doppio tubo coassiale Double coaxial pipe</i>	500	20	164	294000	30	125 (~5")	200/125X	1500	CF6A060-150-2X-D2-5	
								3000	CF6A060-300-2X-D2-5	
								6000	CF6A060-600-2X-D2-5	
273 x 20 133 x 4 <i>Doppio tubo coassiale Double coaxial pipe</i>	500	20	164	294000	30	125 (~5")	25-HD5	1500	CF6A060-150-25-D2-5	
								3000	CF6A060-300-25-D2-5	
								6000	CF6A060-600-25-D2-5	

Diam. esterno	D. interno (D. tubo) x spess. tubo	Passo	Spessore Spira	Alt. spira	Mom. torcente massimo		D. pass. interno	Attacco	Lungh.	Codice
External Diam.	Internal Diam. (Pipe Diam.) x pipe th.	Pitch	Flight Thickness	Flight height	Maximum torque		Internal hole diam.	Coupl.	Length	Part Number
Øe (mm)	Øi (mm)	P (mm)	T (mm)	H (mm)	N · m	Ton · m	Øp (mm)		L (mm)	
700	152,4 x 25	600	14	274	103000	10,5	100 (~4")	HD4	1800	CF0A070-150-H4-15-4
									3000	CF0A070-300-H4-15-4
									6000	CF0A070-600-H4-15-4
	152,4 x 14,2	600	14	274	118000	12	125 (~5")	160/125	1800	CF1A070-150-16-15-4
									3000	CF1A070-300-16-15-4
									6000	CF1A070-600-16-15-4
	152,4 x 14,2	600	14	274	118000	12	125 (~5")	HD5	1800	CF1A070-150-H5-15-4
									3000	CF1A070-300-H5-15-4
									6000	CF1A070-600-H5-15-4
	159 x 16	600	14	271	147000	15	125 (~5")	160/125	1800	CF2A070-150-16-16-4
									3000	CF2A070-300-16-16-4
									6000	CF2A070-600-16-16-4
	159 x 16	600	14	271	147000	15	125 (~5")	HD5	1800	CF2A070-150-H5-16-4
									3000	CF2A070-300-H5-16-4
									6000	CF2A070-600-H5-16-4
	168 x 20	600	20	266	177000	18	125 (~5")	160/125	1800	CF3A070-150-16-17-5
									3000	CF3A070-300-16-17-5
									6000	CF3A070-600-16-17-5
	168 x 20	600	20	266	177000	18	125 (~5")	HD5	1800	CF3A070-150-H5-17-5
									3000	CF3A070-300-H5-17-5
									6000	CF3A070-600-H5-17-5
	177,8 x 20	600	20	261	216000	22	125 (~5")	XHD5	1800	CF4A070-150-X5-18-5
									3000	CF4A070-300-X5-18-5
									6000	CF4A070-600-X5-18-5
177,8 x 20	600	20	261	216000	22	125 (~5")	HD5	1800	CF4A070-150-H5-18-5	
								3000	CF4A070-300-H5-18-5	
								6000	CF4A070-600-H5-18-5	
219 x 20 133 x 4 <i>Doppio tubo coassiale Double coaxial pipe</i>	600	20	241	245000	25	125 (~5")	200/125	1800	CF5A070-150-20-D1-5	
								3000	CF5A070-300-20-D1-5	
								6000	CF5A070-600-20-D1-5	
219 x 20 133 x 4 <i>Doppio tubo coassiale Double coaxial pipe</i>	600	20	241	245000	25	125 (~5")	XHD5	1800	CF5A070-150-X5-D1-5	
								3000	CF5A070-300-X5-D1-5	
								6000	CF5A070-600-X5-D1-5	
273 x 20 133 x 4 <i>Doppio tubo coassiale Double coaxial pipe</i>	600	20	214	294000	30	125 (~5")	200/125X	1800	CF6A070-150-2X-D2-5	
								3000	CF6A070-300-2X-D2-5	
								6000	CF6A070-600-2X-D2-5	
273 x 20 133 x 4 <i>Doppio tubo coassiale Double coaxial pipe</i>	600	20	214	294000	30	125 (~5")	25-HD5	1800	CF6A070-150-25-D2-5	
								3000	CF6A070-300-25-D2-5	
								6000	CF6A070-600-25-D2-5	
800	152,4 x 25	600	14	324	103000	10,5	100 (~4")	HD4	1800	CF0A080-150-H4-15-4
									3000	CF0A080-300-H4-15-4
									6000	CF0A080-600-H4-15-4
	152,4 x 14,2	600	14	324	118000	12	125 (~5")	160/125	1800	CF1A080-150-16-15-4
									3000	CF1A080-300-16-15-4
									6000	CF1A080-600-16-15-4
	152,4 x 14,2	600	14	324	118000	12	125 (~5")	HD5	1800	CF1A080-150-H5-15-4
									3000	CF1A080-300-H5-15-4
									6000	CF1A080-600-H5-15-4
	159 x 16	600	14	321	147000	15	125 (~5")	160/125	1800	CF2A080-150-16-16-4
									3000	CF2A080-300-16-16-4
									6000	CF2A080-600-16-16-4
	159 x 16	600	14	321	147000	15	125 (~5")	HD5	1800	CF2A080-150-H5-16-4
									3000	CF2A080-300-H5-16-4
									6000	CF2A080-600-H5-16-4
	168 x 20	600	20	316	177000	18	125 (~5")	160/125	1800	CF3A080-150-16-17-5
									3000	CF3A080-300-16-17-5
									6000	CF3A080-600-16-17-5
	168 x 20	600	20	316	177000	18	125 (~5")	HD5	1800	CF3A080-150-H5-17-5
									3000	CF3A080-300-H5-17-5
									6000	CF3A080-600-H5-17-5
	177,8 x 20	600	20	311	216000	22	125 (~5")	XHD5	1800	CF4A080-150-X5-18-5
									3000	CF4A080-300-X5-18-5
									6000	CF4A080-600-X5-18-5

Diam. esterno	D. interno (D. tubo) x spess. tubo	Passo	Spessore Spira	Alt. spira	Mom. torcente massimo		D. pass. interno	Attacco	Lungh.	Codice
External Diam.	Internal Diam. (Pipe Diam.) x pipe th.	Pitch	Flight Thickness	Flight height	Maximum torque		Internal hole diam.	Coupl.	Length	Part Number
Øe (mm)	Øi (mm)	P (mm)	T (mm)	H (mm)	N · m	Ton · m	Øp (mm)		L (mm)	
800	177,8 x 20	600	20	311	216000	22	125 (~5")	HD5	1800	CF4A080-150-H5-18-5
									3000	CF4A080-300-H5-18-5
									6000	CF4A080-600-H5-18-5
	219 x 20 133 x 4 <i>Doppio tubo coassiale Double coaxial pipe</i>	600	20	291	245000	25	125 (~5")	200/125	1800	CF5A080-150-20-D1-5
									3000	CF5A080-300-20-D1-5
									6000	CF5A080-600-20-D1-5
	219 x 20 133 x 4 <i>Doppio tubo coassiale Double coaxial pipe</i>	600	20	291	245000	25	125 (~5")	XHD5	1800	CF5A080-150-X5-D1-5
									3000	CF5A080-300-X5-D1-5
									6000	CF5A080-600-X5-D1-5
	273 x 20 133 x 4 <i>Doppio tubo coassiale Double coaxial pipe</i>	600	20	264	294000	30	125 (~5")	200/125X	1800	CF6A080-150-2X-D2-5
									3000	CF6A080-300-2X-D2-5
									6000	CF6A080-600-2X-D2-5
	273 x 20 133 x 4 <i>Doppio tubo coassiale Double coaxial pipe</i>	600	20	264	294000	30	125 (~5")	25-HD5	1800	CF6A080-150-25-D2-5
									3000	CF6A080-300-25-D2-5
									6000	CF6A080-600-25-D2-5
900	152,4 x 25	600	14	374	103000	10,5	100 (~4")	HD4	1800	CF0A090-150-H4-15-4
									3000	CF0A090-300-H4-15-4
									6000	CF0A090-600-H4-15-4
	152,4 x 14,2	600	14	374	118000	12	125 (~5")	160/125	1800	CF1A090-150-16-15-4
									3000	CF1A090-300-16-15-4
									6000	CF1A090-600-16-15-4
	152,4 x 14,2	600	14	374	118000	12	125 (~5")	HD5	1800	CF1A090-150-H5-15-4
									3000	CF1A090-300-H5-15-4
									6000	CF1A090-600-H5-15-4
	159 x 16	600	14	371	147000	15	125 (~5")	160/125	1800	CF2A090-150-16-16-4
									3000	CF2A090-300-16-16-4
									6000	CF2A090-600-16-16-4
	159 x 16	600	14	371	147000	15	125 (~5")	HD5	1800	CF2A090-150-H5-16-4
									3000	CF2A090-300-H5-16-4
									6000	CF2A090-600-H5-16-4
	168 x 20	600	20	366	177000	18	125 (~5")	160/125	1800	CF3A090-150-16-17-5
									3000	CF3A090-300-16-17-5
									6000	CF3A090-600-16-17-5
	168 x 20	600	20	366	177000	18	125 (~5")	HD5	1800	CF3A090-150-H5-17-5
									3000	CF3A090-300-H5-17-5
									6000	CF3A090-600-H5-17-5
	177,8 x 20	600	20	361	216000	22	125 (~5")	XHD5	1800	CF4A090-150-X5-18-5
									3000	CF4A090-300-X5-18-5
									6000	CF4A090-600-X5-18-5
	177,8 x 20	600	20	361	216000	22	125 (~5")	HD5	1800	CF4A090-150-H5-18-5
									3000	CF4A090-300-H5-18-5
									6000	CF4A090-600-H5-18-5
219 x 20 133 x 4 <i>Doppio tubo coassiale Double coaxial pipe</i>	600	20	341	245000	25	125 (~5")	200/125	1800	CF5A090-150-20-D1-5	
								3000	CF5A090-300-20-D1-5	
								6000	CF5A090-600-20-D1-5	
219 x 20 133 x 4 <i>Doppio tubo coassiale Double coaxial pipe</i>	600	20	341	245000	25	125 (~5")	XHD5	1800	CF5A090-150-X5-D1-5	
								3000	CF5A090-300-X5-D1-5	
								6000	CF5A090-600-X5-D1-5	
273 x 20 133 x 4 <i>Doppio tubo coassiale Double coaxial pipe</i>	600	20	314	294000	30	125 (~5")	200/125X	1800	CF6A090-150-2X-D2-5	
								3000	CF6A090-300-2X-D2-5	
								6000	CF6A090-600-2X-D2-5	
273 x 20 133 x 4 <i>Doppio tubo coassiale Double coaxial pipe</i>	600	20	314	294000	30	125 (~5")	25-HD5	1800	CF6A090-150-25-D2-5	
								3000	CF6A090-300-25-D2-5	
								6000	CF6A090-600-25-D2-5	

Diam. esterno	D. interno (D. tubo) x spess. tubo	Passo	Spessore Spira	Alt. spira	Mom. torcente massimo		D. pass. interno	Attacco	Lungh.	Codice
External Diam.	Internal Diam. (Pipe Diam.) x pipe th.	Pitch	Flight Thickness	Flight height	Maximum torque		Internal hole diam.	Coupl.	Length	Part Number
Øe (mm)	Øi (mm)	P (mm)	T (mm)	H (mm)	N · m	Ton · m	Øp (mm)		L (mm)	
1000	152,4 x 14,2	600	14	424	118000	12	125 (~5")	160/125	1800	CF1A100-150-16-15-4
									3000	CF1A100-300-16-15-4
									6000	CF1A100-600-16-15-4
	152,4 x 14,2	600	14	424	118000	12	125 (~5")	HD5	1800	CF1A100-150-H5-15-4
									3000	CF1A100-300-H5-15-4
									6000	CF1A100-600-H5-15-4
	159 x 16	600	14	421	147000	15	125 (~5")	160/125	1800	CF2A100-150-16-16-4
									3000	CF2A100-300-16-16-4
									6000	CF2A100-600-16-16-4
	159 x 16	600	14	421	147000	15	125 (~5")	HD5	1800	CF2A100-150-H5-16-4
									3000	CF2A100-300-H5-16-4
									6000	CF2A100-600-H5-16-4
	168 x 20	600	20	416	177000	18	125 (~5")	160/125	1800	CF3A100-150-16-17-5
									3000	CF3A100-300-16-17-5
									6000	CF3A100-600-16-17-5
	168 x 20	600	20	416	177000	18	125 (~5")	HD5	1800	CF3A100-150-H5-17-5
									3000	CF3A100-300-H5-17-5
									6000	CF3A100-600-H5-17-5
	177,8 x 20	600	20	411	216000	22	125 (~5")	XHD5	1800	CF4A100-150-X5-18-5
									3000	CF4A100-300-X5-18-5
									6000	CF4A100-600-X5-18-5
	177,8 x 20	600	20	411	216000	22	125 (~5")	HD5	1800	CF4A100-150-H5-18-5
									3000	CF4A100-300-H5-18-5
									6000	CF4A100-600-H5-18-5
219 x 20 133 x 4 <i>Doppio tubo coassiale Double coaxial pipe</i>	600	20	391	245000	25	125 (~5")	200/125	1800	CF5A100-150-20-D1-5	
								3000	CF5A100-300-20-D1-5	
								6000	CF5A100-600-20-D1-5	
219 x 20 133 x 4 <i>Doppio tubo coassiale Double coaxial pipe</i>	600	20	391	245000	25	125 (~5")	XHD5	1800	CF5A100-150-X5-D1-5	
								3000	CF5A100-300-X5-D1-5	
								6000	CF5A100-600-X5-D1-5	
273 x 20 133 x 4 <i>Doppio tubo coassiale Double coaxial pipe</i>	600	20	364	294000	30	125 (~5")	200/125X	1800	CF6A100-150-2X-D2-5	
								3000	CF6A100-300-2X-D2-5	
								6000	CF6A100-600-2X-D2-5	
273 x 20 133 x 4 <i>Doppio tubo coassiale Double coaxial pipe</i>	600	20	364	294000	30	125 (~5")	25-HD5	1800	CF6A100-150-25-D2-5	
								3000	CF6A100-300-25-D2-5	
								6000	CF6A100-600-25-D2-5	

Carandina s.r.l. migliora costantemente i propri prodotti riservandosi il diritto di apportare qualsiasi modifica senza preavviso.-Carandina s.r.l. continually improve its products reserving the right to modify data without warning.

Diam. esterno	D. interno (D. tubo) x spess. tubo	Passo	Spessore Spira	Alt. spira	Mom. torcente massimo		D. pass. interno	Attacco	Lungh.	Codice
External Diam.	Internal Diam. (Pipe Diam.) x pipe th.	Pitch	Flight Thickness	Flight height	Maximum torque		Internal hole diam.	Coupl.	Length	Part Number
Øe (mm)	Øi (mm)	P (mm)	T (mm)	H (mm)	N · m	Ton · m	Øp (mm)		L (mm)	
1100	152,4 x 14,2	600	14	474	118000	12	125 (~5")	160/125	1800	CF1A110-150-16-15-4
									3000	CF1A110-300-16-15-4
									6000	CF1A110-600-16-15-4
	152,4 x 14,2	600	14	474	118000	12	125 (~5")	HD5	1800	CF1A110-150-H5-15-4
									3000	CF1A110-300-H5-15-4
									6000	CF1A110-600-H5-15-4
	159 x 16	600	14	471	147000	15	125 (~5")	160/125	1800	CF2A110-150-16-16-4
									3000	CF2A110-300-16-16-4
									6000	CF2A110-600-16-16-4
	159 x 16	600	14	471	147000	15	125 (~5")	HD5	1800	CF2A110-150-H5-16-4
									3000	CF2A110-300-H5-16-4
									6000	CF2A110-600-H5-16-4
	168 x 20	600	20	466	177000	18	125 (~5")	160/125	1800	CF3A110-150-16-17-5
									3000	CF3A110-300-16-17-5
									6000	CF3A110-600-16-17-5
	168 x 20	600	20	466	177000	18	125 (~5")	HD5	1800	CF3A110-150-H5-17-5
									3000	CF3A110-300-H5-17-5
									6000	CF3A110-600-H5-17-5
	177,8 x 20	600	20	461	216000	22	125 (~5")	XHD5	1800	CF4A110-150-X5-18-5
									3000	CF4A110-300-X5-18-5
									6000	CF4A110-600-X5-18-5
	177,8 x 20	600	20	461	216000	22	125 (~5")	HD5	1800	CF4A110-150-H5-18-5
									3000	CF4A110-300-H5-18-5
									6000	CF4A110-600-H5-18-5
219 x 20 133 x 4 <i>Doppio tubo coassiale Double coaxial pipe</i>	600	20	441	245000	25	125 (~5")	200/125	1800	CF5A110-150-20-D1-5	
								3000	CF5A110-300-20-D1-5	
								6000	CF5A110-600-20-D1-5	
219 x 20 133 x 4 <i>Doppio tubo coassiale Double coaxial pipe</i>	600	20	441	245000	25	125 (~5")	XHD5	1800	CF5A110-150-X5-D1-5	
								3000	CF5A110-300-X5-D1-5	
								6000	CF5A110-600-X5-D1-5	
273 x 20 133 x 4 <i>Doppio tubo coassiale Double coaxial pipe</i>	600	20	414	294000	30	125 (~5")	200/125X	1800	CF6A110-150-2X-D2-5	
								3000	CF6A110-300-2X-D2-5	
								6000	CF6A110-600-2X-D2-5	
273 x 20 133 x 4 <i>Doppio tubo coassiale Double coaxial pipe</i>	600	20	414	294000	30	125 (~5")	25-HD5	1800	CF6A110-150-25-D2-5	
								3000	CF6A110-300-25-D2-5	
								6000	CF6A110-600-25-D2-5	

Carandina s.r.l. migliora costantemente i propri prodotti riservandosi il diritto di apportare qualsiasi modifica senza preavviso.-Carandina s.r.l. continually improve its products reserving the right to modify data without warning.



Diam. esterno	D. interno (D. tubo) x spess. tubo	Passo	Spessore Spira	Alt. spira	Mom. torcente massimo		D. pass. interno	Attacco	Lungh.	Codice
External Diam.	Internal Diam. (Pipe Diam.) x pipe th.	Pitch	Flight Thickness	Flight height	Maximum torque		Internal hole diam.	Coupl.	Length	Part Number
Øe (mm)	Øi (mm)	P (mm)	T (mm)	H (mm)	N · m	Ton · m	Øp (mm)		L (mm)	
1200	159 x 16	600	14	521	147000	15	125 (~5")	160/125	1800	CF2A120-150-16-16-4
									3000	CF2A120-300-16-16-4
									6000	CF2A120-600-16-16-4
	159 x 16	600	14	521	147000	15	125 (~5")	HD5	1800	CF2A120-150-H5-16-4
									3000	CF2A120-300-H5-16-4
									6000	CF2A120-600-H5-16-4
	168 x 20	600	20	516	177000	18	125 (~5")	160/125	1800	CF3A120-150-16-17-5
									3000	CF3A120-300-16-17-5
									6000	CF3A120-600-16-17-5
	168 x 20	600	20	516	177000	18	125 (~5")	HD5	1800	CF3A120-150-H5-17-5
									3000	CF3A120-300-H5-17-5
									6000	CF3A120-600-H5-17-5
	177,8 x 20	600	20	511	216000	22	125 (~5")	XHD5	1800	CF4A120-150-X5-18-5
									3000	CF4A120-300-X5-18-5
									6000	CF4A120-600-X5-18-5
	177,8 x 20	600	20	511	216000	22	125 (~5")	HD5	1800	CF4A120-150-H5-18-5
									3000	CF4A120-300-H5-18-5
									6000	CF4A120-600-H5-18-5
	219 x 20 133 x 4 <i>Doppio tubo coassiale Double coaxial pipe</i>	600	20	491	245000	25	125 (~5")	200/125	1800	CF5A120-150-20-D1-5
									3000	CF5A120-300-20-D1-5
									6000	CF5A120-600-20-D1-5
	219 x 20 133 x 4 <i>Doppio tubo coassiale Double coaxial pipe</i>	600	20	491	245000	25	125 (~5")	XHD5	1800	CF5A120-150-X5-D1-5
									3000	CF5A120-300-X5-D1-5
									6000	CF5A120-600-X5-D1-5
273 x 20 133 x 4 <i>Doppio tubo coassiale Double coaxial pipe</i>	600	20	464	294000	30	125 (~5")	200/125X	1800	CF6A120-150-2X-D2-5	
								3000	CF6A120-300-2X-D2-5	
								6000	CF6A120-600-2X-D2-5	
273 x 20 133 x 4 <i>Doppio tubo coassiale Double coaxial pipe</i>	600	20	464	294000	30	125 (~5")	25-HD5	1800	CF6A120-150-25-D2-5	
								3000	CF6A120-300-25-D2-5	
								6000	CF6A120-600-25-D2-5	
1500	159 x 16	600	14	471	147000	15	125 (~5")	160/125	1800	CF2A150-150-16-16-4
									3000	CF2A150-300-16-16-4
									6000	CF2A150-600-16-16-4
	159 x 16	600	14	471	147000	15	125 (~5")	HD5	1800	CF2A150-150-H5-16-4
									3000	CF2A150-300-H5-16-4
									6000	CF2A150-600-H5-16-4
	168 x 20	600	20	466	177000	18	125 (~5")	160/125	1800	CF3A150-150-16-17-5
									3000	CF3A150-300-16-17-5
									6000	CF3A150-600-16-17-5
	168 x 20	600	20	466	177000	18	125 (~5")	HD5	1800	CF3A150-150-H5-17-5
									3000	CF3A150-300-H5-17-5
									6000	CF3A150-600-H5-17-5
	177,8 x 20	600	20	461	216000	22	125 (~5")	XHD5	1800	CF4A150-150-X5-18-5
									3000	CF4A150-300-X5-18-5
									6000	CF4A150-600-X5-18-5
	177,8 x 20	600	20	461	216000	22	125 (~5")	HD5	1800	CF4A150-150-H5-18-5
									3000	CF4A150-300-H5-18-5
									6000	CF4A150-600-H5-18-5
	219 x 20 133 x 4 <i>Doppio tubo coassiale Double coaxial pipe</i>	600	20	441	245000	25	125 (~5")	200/125	1800	CF5A150-150-20-D1-5
									3000	CF5A150-300-20-D1-5
									6000	CF5A150-600-20-D1-5
	219 x 20 133 x 4 <i>Doppio tubo coassiale Double coaxial pipe</i>	600	20	441	245000	25	125 (~5")	XHD5	1800	CF5A150-150-X5-D1-5
									3000	CF5A150-300-X5-D1-5
									6000	CF5A150-600-X5-D1-5
273 x 20 133 x 4 <i>Doppio tubo coassiale Double coaxial pipe</i>	600	20	414	294000	30	125 (~5")	200/125X	1800	CF6A150-150-2X-D2-5	
								3000	CF6A150-300-2X-D2-5	
								6000	CF6A150-600-2X-D2-5	
273 x 20 133 x 4 <i>Doppio tubo coassiale Double coaxial pipe</i>	600	20	414	294000	30	125 (~5")	25-HD5	1800	CF6A150-150-25-D2-5	
								3000	CF6A150-300-25-D2-5	
								6000	CF6A150-600-25-D2-5	